

**M61**



**Technical Data**

- Supply voltage**  
24, 48, 110, 200, 230, 240 Vac ; 50 and 60Hz
- Supply tolerance**  
± 10%
- Power consumption**  
0.7W - 0.9VA at 50Hz ; 0.6W - 0.8VA at 60Hz
- Duty Cycle**  
100%
- Speed**  
375 rpm at 50Hz ; 450 rpm at 60Hz
- Running torque <sup>(1)</sup>**  
0.08 Ncm at 50Hz ; 0.07 Ncm at 60Hz
- Output power <sup>(2)</sup>**  
0.03W at 50Hz ; 0.03W at 60Hz
- Direction of rotation**  
clockwise or anticlockwise (bidirectional on request)
- Number of starts**  
unlimited
- Operating life**  
3 years min., continuous operation
- Stop**  
immediate in case of power failure
- Rotor locking**  
rotor can be locked with motor running
- Output shaft**  
ø 1.5 x 6.2 mm  
hardened and rectified steel
- Insulation voltage**  
2.5KV / 50Hz, between coil and stator
- Temperature range**  
operating: -10°C +55°C  
storage: -30°C +80°C
- Mounting**  
in any position, with fixing brackets  
(page 12.7)
- Connections**  
AWG24 cables L = 155 mm, stripping length 6 mm
- Protections**  
IP30
- Overall dimensions**  
ø 42 x 15 mm
- Weight**  
80 g
- Approvals**  
UL recognized (file No. E105427)

**Unidirectional synchronous motor**

**Applications**

Clocks, timers, cam timers, paper recording devices, level control for granulate, revolving advertising displays, drink dispensers, drink stirrers, power-operated valves, peristaltic pumps, electro-medical equipment, optical instruments, humidifiers, automatic dosage devices, ice makers, solid products dispensers, disco lights, dolls motion, advertising signs, rheostats adjustment, etc.

**General construction**

The **M61** motor, of simple design, is made up of the following components :

- sheet iron stator.
- permanent magnet rotor with 16 poles.
- self-lubricating plastic bearings, which support the output shaft.
- electrical no-reverse device, guaranteeing extremely silent operation.

**Coupling to FIBER gearboxes**

The unidirectional synchronous motor **M61** can be coupled to following gearboxes: **W01, W02, W11.**

**Overall dimensions**

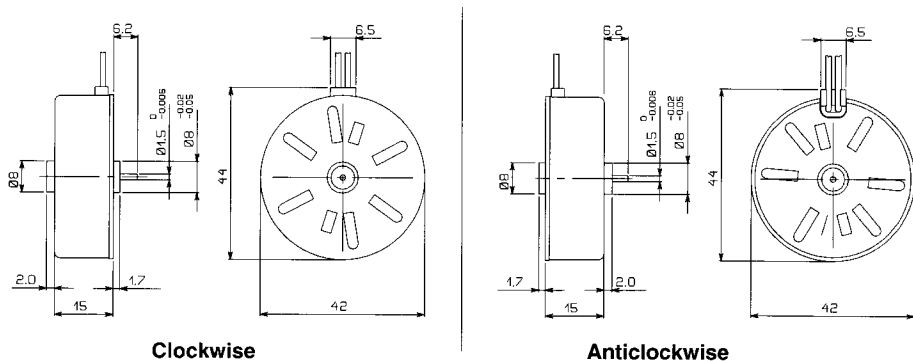

**Ordering code**

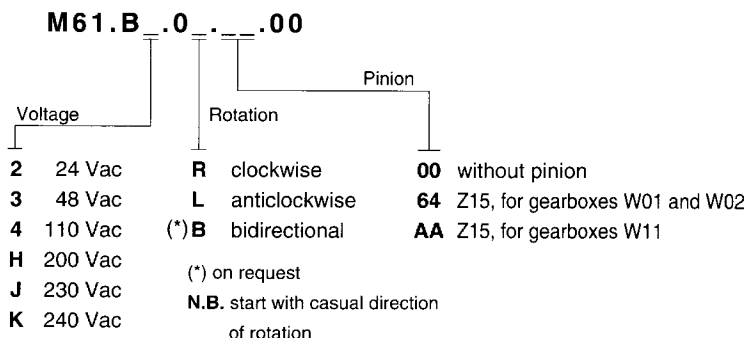

<sup>(1)</sup> Values guaranteed at 0.9 Vn  
<sup>(2)</sup> Values calculated at 0.9 Vn

The M61 motors at 200, 230 and 240 Vac are supplied with pre-cabled resistance.

Other versions on request.